

ONE YEAR WEAR AND TEAR PARTS, GENERAL LIST

SPARES FOR BURNER ASSEMBLY

Nozzle I
Nozzle II
Cover gasket

SPARES FOR COMBUSTION CHAMBER ASSEMBLY

Glass fibre rope (door gasket)
Sealing compound (glue for door gasket)

SPARES FOR SLUDGE DOSAGE ASSEMBLY

Bonded stator
Rotor
Universal joint
Stuffing box gasket

SPARES FOR FLUE GAS FAN ASSEMBLY

V-belts

The exact content is depending on the incinerator model and production year.

OUR EXPERIENCE:

- We know what the user needs
- We have compiled the most important parts

WEAR AND TEAR PARTS KIT:

- All parts that should be changed during one year operation
- Should be replaced regularly with normal preventive maintenance

RECOMMENDED ONBOARD REPAIR KIT:

- Keep onboard at any given time for unforeseen events
- Most common causes of downtime can be eliminated
- Consumed parts should be replaced with new

ALWAYS MAINTAIN RECOMMENDED LEVEL OF PREPAREDNESS!



RECOMMENDED ONBOARD REPAIR PARTS, GENERAL LIST

SPARES FOR BURNER ASSEMBLY

Flame scrod
Blast tube
Ignition cables
Nozzle line
Sludge burner assembly
Pressure regulator kit
Photo resistor
Ignition electrodes
Solenoid valve
Spline coupling compl.
Shaft seal kit

SPARES FOR SLUDGE DOSAGE ASSEMBLY

Repair kit for sludge valve
Solenoid valve I, atomizing
Solenoid valve II, atomizing
Seal plate gasket
Mechanical seal
Stuffing box gasket
Thermocouple with pocket

SPARES FOR COMBUSTION CHAMBER ASSEMBLY

Repair substance for refractory
Thermocouple
Flue gas restriction ring bricks

SPARES FOR FLUE GAS FAN ASSEMBLY

Thermocouple
Shaft bearings

The exact content is depending on model and production year.

TeamTec

SIMPLY BETTER

www.teamtec.no | TeamTec AS | Nyvei 41 | P.O. Box 203 | N-4902 Tvedestrand | Norway | Switchboard: +47 37 19 98 00 | Mail: spares@teamtec.no

TeamTec

SIMPLY BETTER



GENUINE SPARE PARTS FOR INCINERATORS

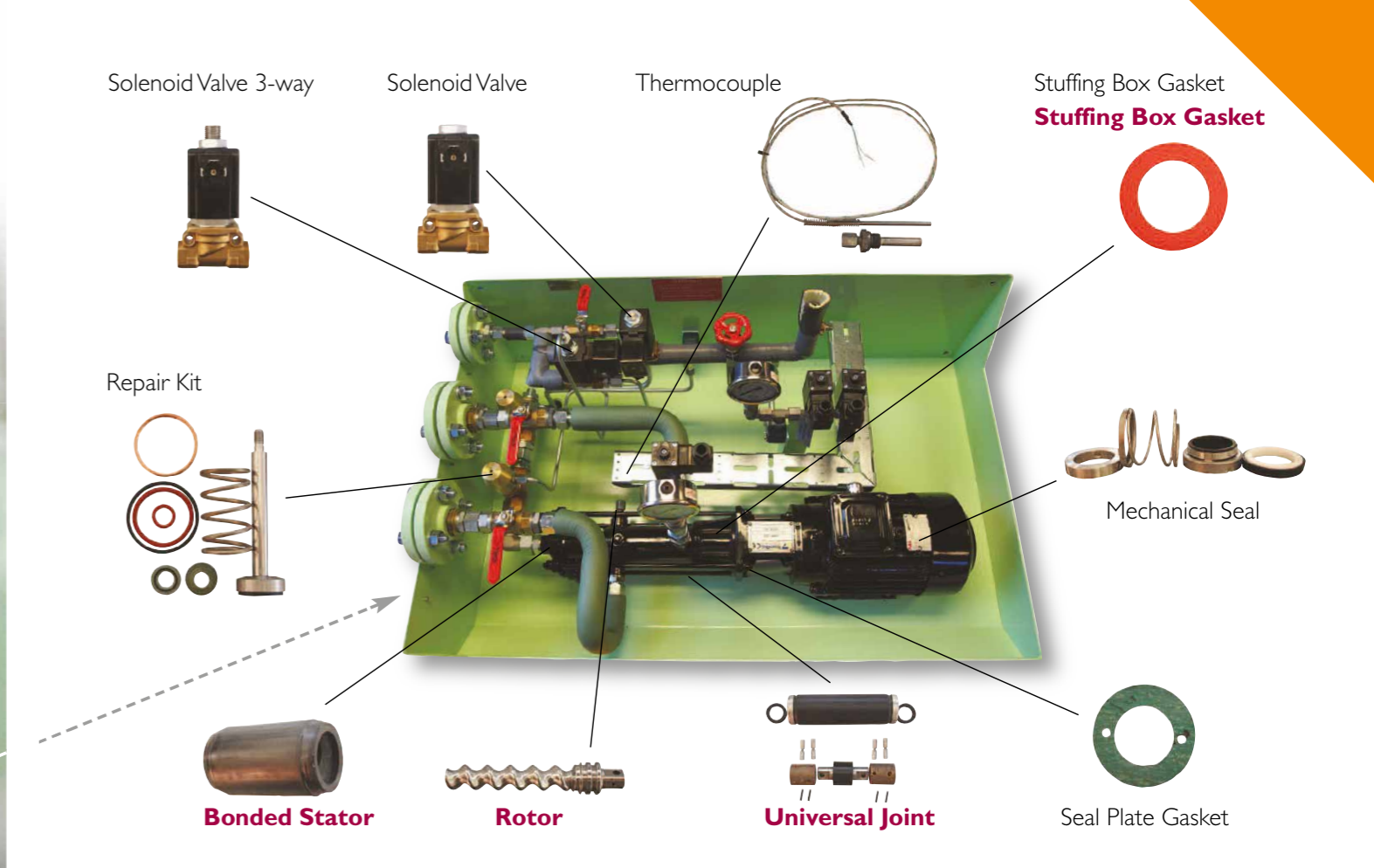
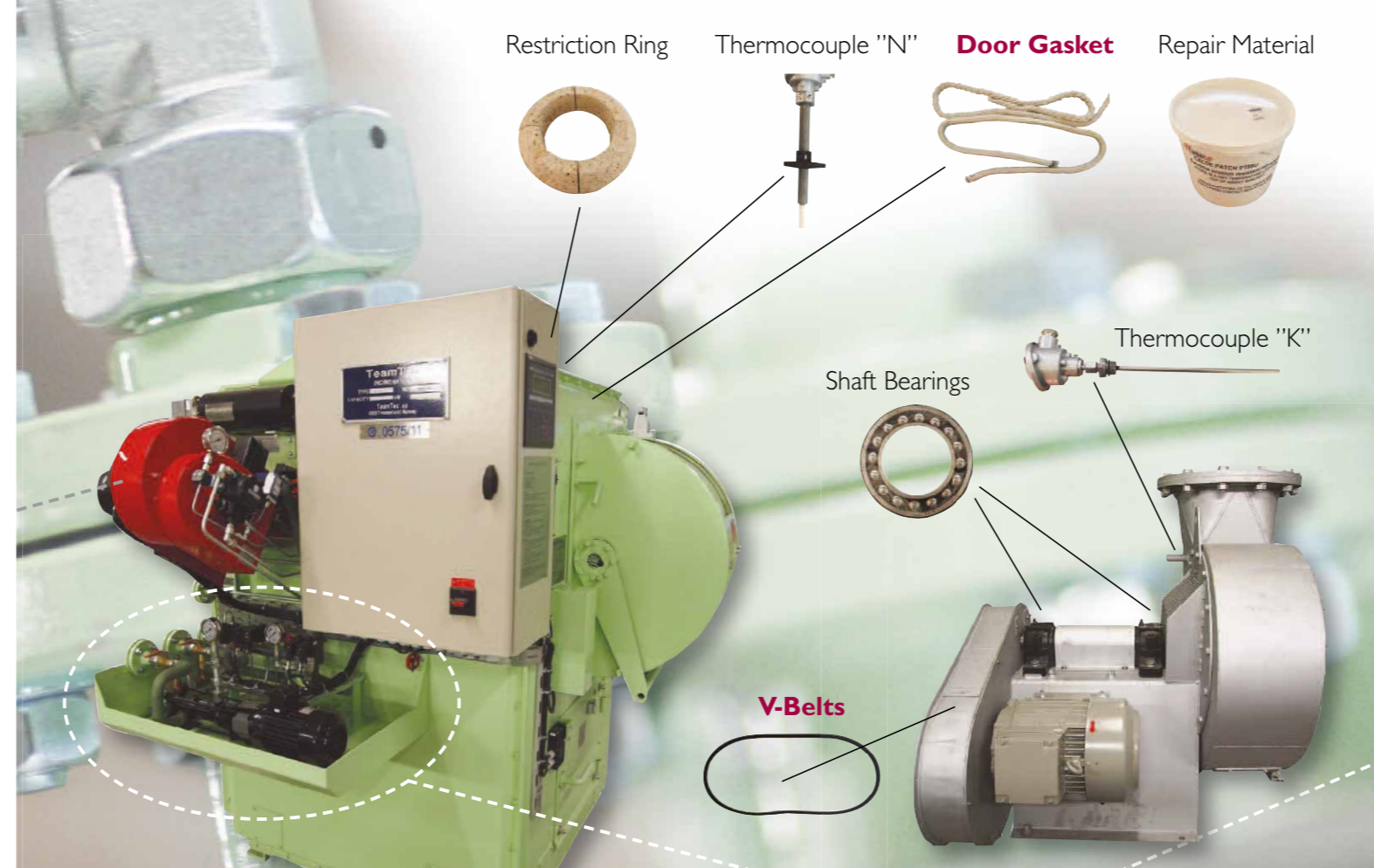
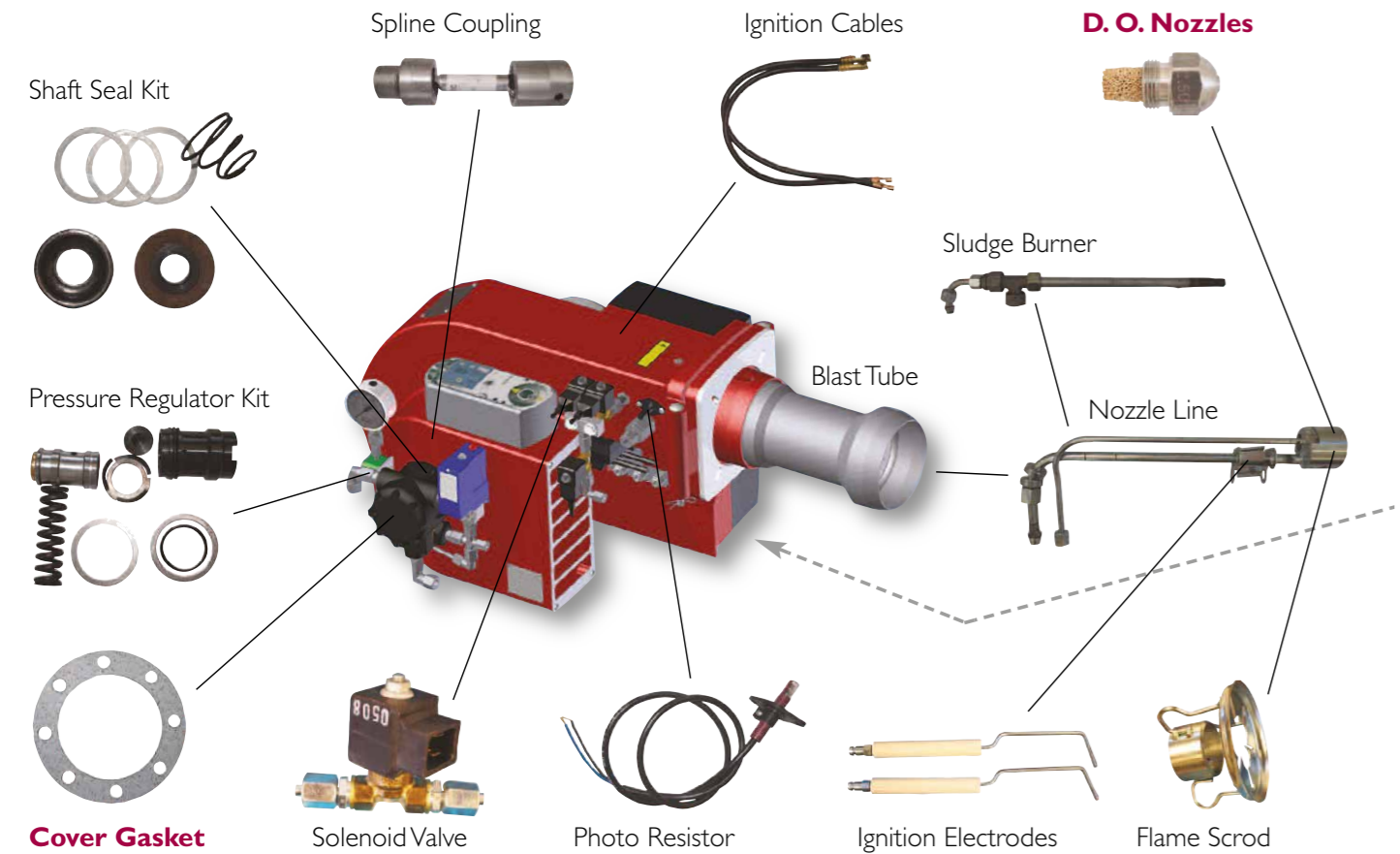

RED TEXT: One year wear and tear parts.

BLACK TEXT: Recommended on board repair parts.